

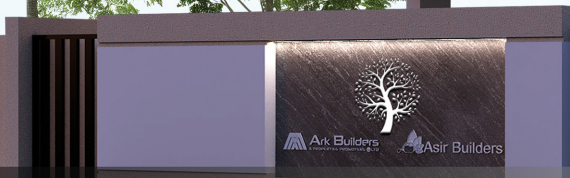

Uniting Luxury and  
Privacy in Urban Living





\*Premium interiors at additional cost



## Setting the Standard for Contemporary Living

Ark White Tree, a visionary residential marvel situated in the heart of Perumalpuram, Tirunelveli. Redefining [contemporary living](#) with its innovative One Floor One Unit concept, this avant-garde project stands tall with its stilt + 5 floors, offering a fusion of luxury and privacy like never before.

Nestled amidst the vibrant urban landscape of Tirunelveli, Ark White Tree epitomizes modern elegance, seamlessly blending [sophisticated design](#) with unparalleled comfort. Every aspect of this esteemed development has been meticulously crafted to provide residents with an exceptional living experience, where style and functionality converge effortlessly.

3 BHK apartments @ Perumalpuram, Tirunelveli



JUMBO COLLECTION





**UNIT A**

Saleable Area - 856 Sq.Ft

UDS - 297.94 Sq.Ft

---

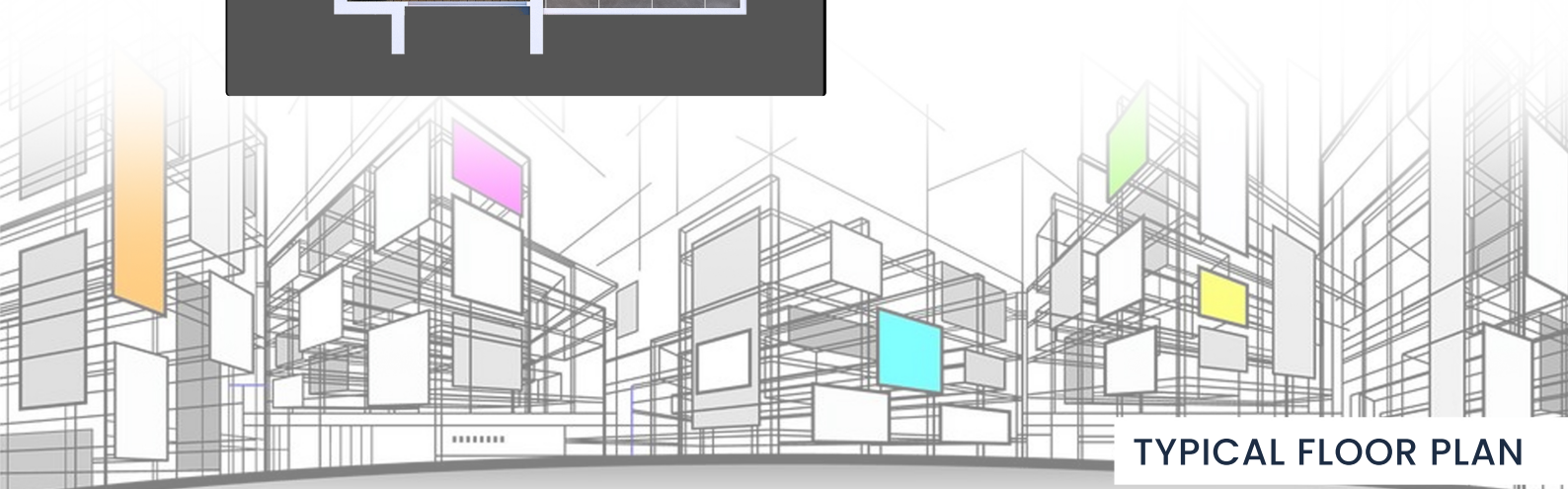

**TYPICAL FLOOR PLAN**

# SPECIFICATIONS AND FEATURES

## STRUCTURE

- Foundation shall be as per Structural Drawings
- RCC Framed Structure
- AAC Block masonry and plastering

## KITCHEN

- Dado above Kitchen Platform in Glazed tiles
- Provision for Washing Machine in utility area
- Kitchen Platform of black polished granite top with CARYSIL Sink
- Provision for Water Purification System
- Provision for Exhaust fan/ Chimney

## JOINARIES

- Main Door Teak Wood with Solid Shutter
- First Class Solid Wood frame with flush Door Shutters for Bedrooms and Toilets
- Windows UPVC

## FLOORING

- Living/dining bedrooms- Premium Vitrified Flooring
- Lobby - Vitrified Tile Flooring , Lift wall Cladding vitrified tile.
- Staircase and Landings Granite Flooring as specified by the Architect

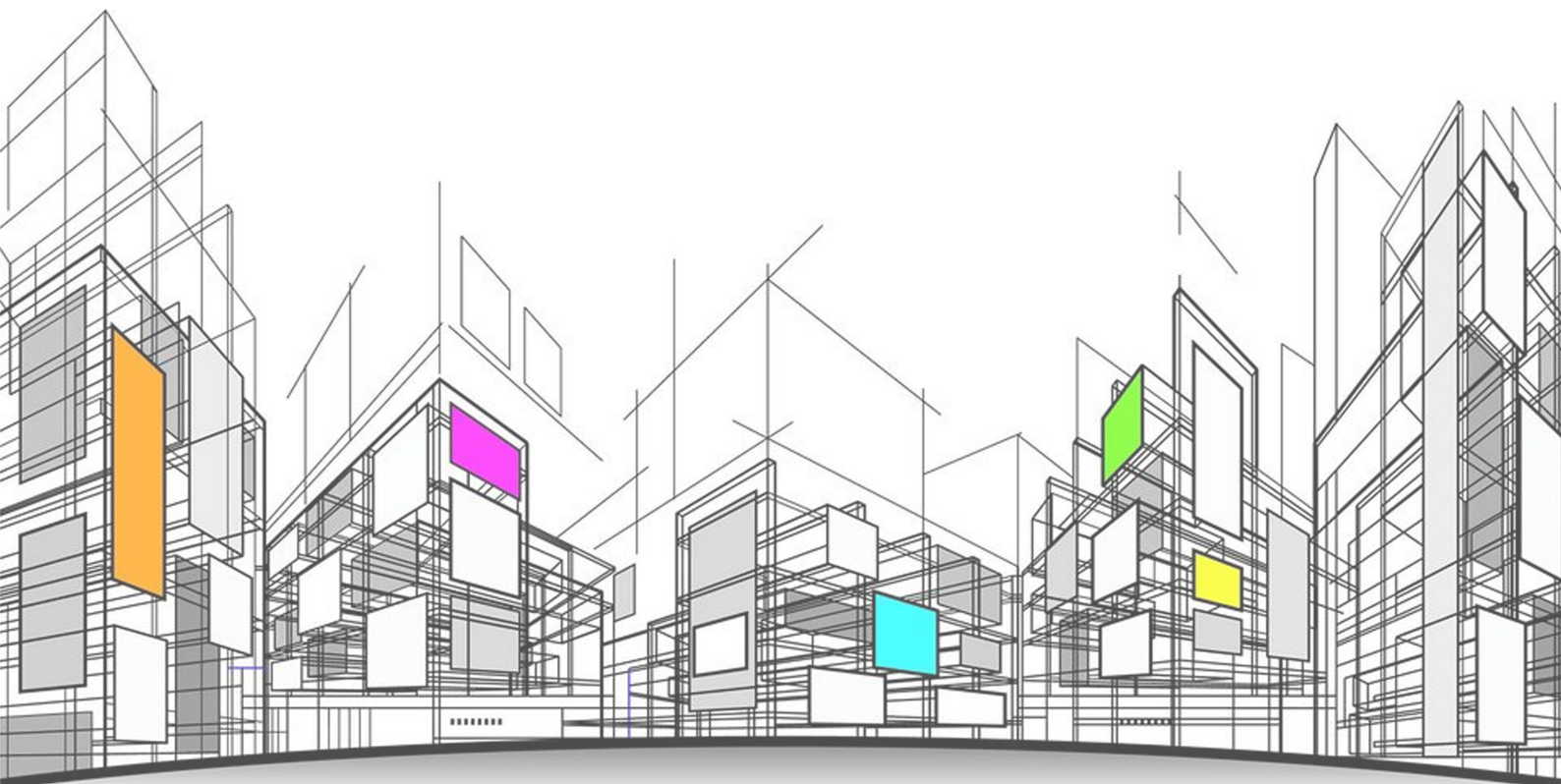

## BATHROOMS

- Glazed Designer Ceramic/ Porcelain wall tile up to Lintel level
- Anti-Skid Tile flooring
- Wall Mounted Wash Basin from KOHLER or equivalent
- Wall Mounted EWC Closets with Health faucet from KOHLER or equivalent
- Wall Mixer from KOHLER or equivalent with shower for Hot and Cold water
- All CP fittings and Sanitary fittings from KOHLER or equivalent
- Provision for GEYSER
- Provision for exhaust fan

## COMMON AMENITIES

- OTIS / KONE or equivalent with automatic Rescue. Device(ARD)
- Standby Generator for Common Area power backup
- Grano flooring for Driveways & Parking Anti-Termite Treatment
- Common Toilet for Servants / Drivers
- Alotted Car Parking Area
- Rain Water Harvesting
- Adequate Light in the Common Area

## ELECTRICALS

- 3 Phase power supply with concealed wiring of low smoke(FRLS) from FINOLEX/ HAVELLS or equivalent
- Modular Switches from LEGRAND / HAVELLS or equivalent
- DTH / Cable TV Provision
- Independent Distribution Board from LEGRAND / HAVELLS or equivalent with one ELCB
- All bedrooms will be provided with a point for Air Conditioner

## PAINTINGS

- Interiors: Emulsion Premium Paint from ICI / ASIAN PAINTS or equivalent with two coats of BIRLA wall care patty
- Exteriors: Premium finish with ICI / ASIAN equivalent
- MS grills with two coats of synthetic enamel paint from ICI / ASIAN or equivalent

## ADDITIONAL FEATURES @ extra cost

1. Centralized Air Conditioning
2. Architected Interior
3. Wood works & False ceiling
4. Smart home provision & Automation

## SITE ADDRESS



"Ark White Tree", Door No. 3A & 3A1, Perumalpuram,  
7th Street, Tirunelveli- 627 007

 +91-93621 72210       info@arkbuilders.co.in

## CORPORATE OFFICE

**Ark Builders & Properties Promoters Pvt. Ltd.**

"Art of Ark", No. 6/9, 1st Cross Street,  
Maharajanagar, Palayamkottai,  
Tirunelveli - 627 001.

 +91-93621 72210  
 info@arkbuilders.co.in

## CHENNAI OFFICE

**Ark Builders & Properties Promoters Pvt. Ltd.**

"Art Bliss", No.8, 4th Main Road,  
United India Colony,Kodambakkam,  
Chennai - 600 024.

 +91-63748 72399  
 sales@arkbuilders.co.in



Disclaimer: The furniture / images shown in the brochure are only for the purpose of illustrating a possible layout and do not form a part of the offering. Information herein is subject to change as and when required. Ark Builders Properties & Promoters (P) Ltd reserves the right to add or delete any specification and other details mentioned herein without prior permission or notice.